

Mission-Simulation Assignment

Operation Bricklayer

Dr. Winnie has decided to redo the walk in front of her house with unusual **right-triangle bricks**. Each of the nine large bricks are **exactly identical**: the base and height are 8 feet each, and the hypotenuse is 11.3 feet.

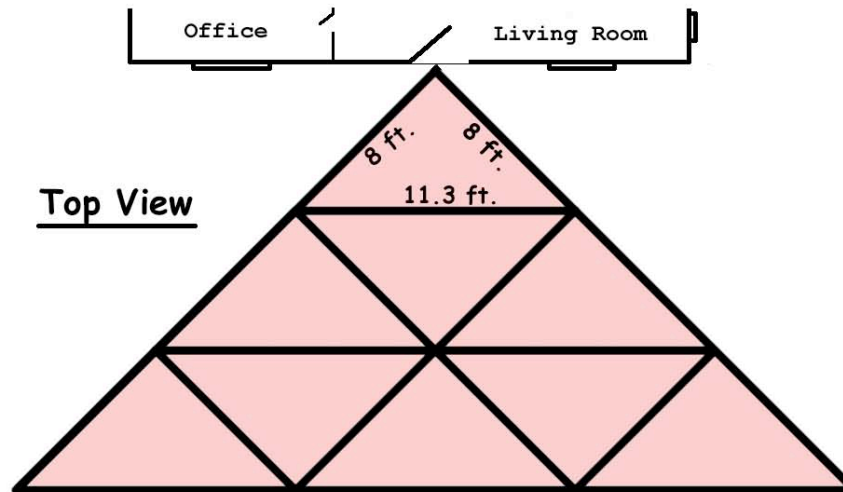

Step A

What is the total area of Dr. Winnie's new walkway?

Step B

- Use what you know about area to explain why the area you calculated for Dr. Winnie's walkway is correct. Use words and numbers to explain your thoughts.

- Suppose Dr. Winnie decides to use different triangular bricks that have a base of 4 and height of 4. Use words, numbers, and/or symbols to explain how using the different bricks will affect the total area of the walkway.
