

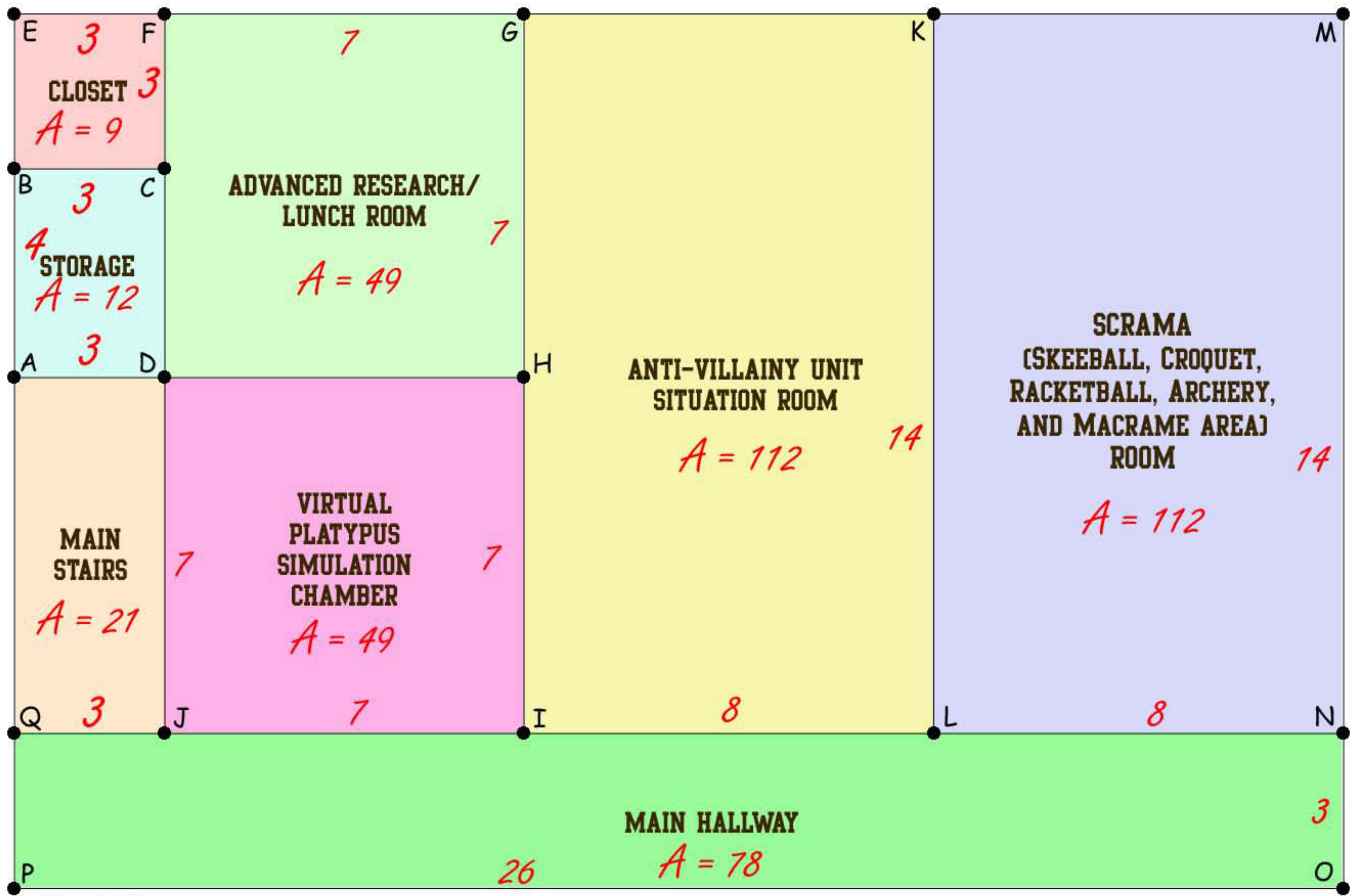

Training Mission - Floorplan Mayhem - Answer Key

Mathbot is trying to create an office floorplan, but unfortunately the robot has short-circuited...again. Instead of easy wall measurements and areas, Mathbot created a floorplan with the points, lines, and weird instructions you see below.

Directions: Use Mathbot's Instruction List to figure out the length of each wall on the floorplan. Check off each step on the list as you work. Then figure out the area of the entire floor (the shape EMOP) and write it under Mathbot's list.



- Mathbot's Instruction List**
- Length of AD = 3
 - The area of ABCD is 12
 - Length of DF = 7
 - BCFE is a square
 - DFGH is a square
 - Length of GH is the same as HI
 - Length of IL is twice the length of AB
 - GKLI is identical to KMNL
 - Area of NOPQ is 78 sq. feet

Total Floor Area

442 sq. ft

Next Step:

Write a sentence explaining how you calculated the total area of the floor.

Students might calculate each room individually and add, or find the length and width of the entire floor (26x17) to multiply.